

Bauer EM

Quick Reference Card

Please see our website at
www.bauerproducts.com for detailed
instructions, and videos on installation
and operation.

Bauer 
Products

Bauer Products, Inc.

702 Evergreen St SE

Grand Rapids, MI 49507

1-866-68-BAUER(22837)

www.bauerproducts.com

email: info@bauerproducts.com

Bauer EM Operation

IMPORTANT:
The Touch Pad
Only Activates the
Dead Bolt

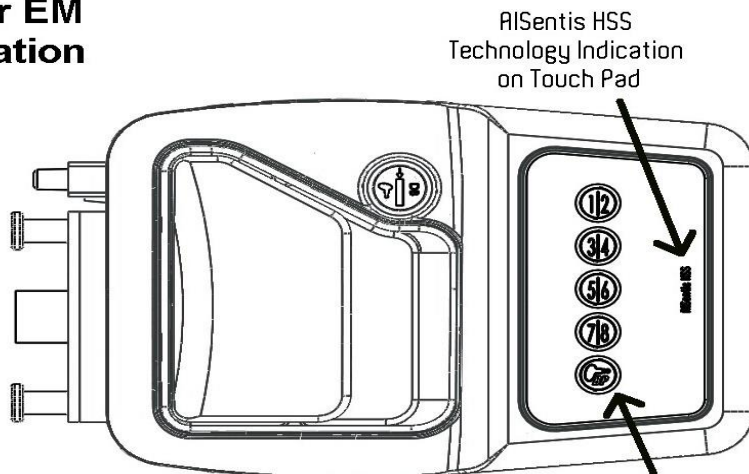

Please enter your Personal Code
upon Installation of lock to prevent
inadvertent programming.

1. Touch the first Button of
the code you wish to enter.
The Buttons will illuminate to
indicate the lock is ready to
accept the code.

2. The factory default code is
3,7,1,5 followed by the Enter
Button.

3. To set your Personal Code.
Simultaneously touch and
hold the "3|4" Button and
Enter Button for 2 seconds.
The lock will beep 3 times to
accept the new code.

4. Enter a 4 digit code
followed by the Enter Button.
The lock will beep 4 times to
indicate new code
acceptance. This is now your
new code.

**Enter
Button**

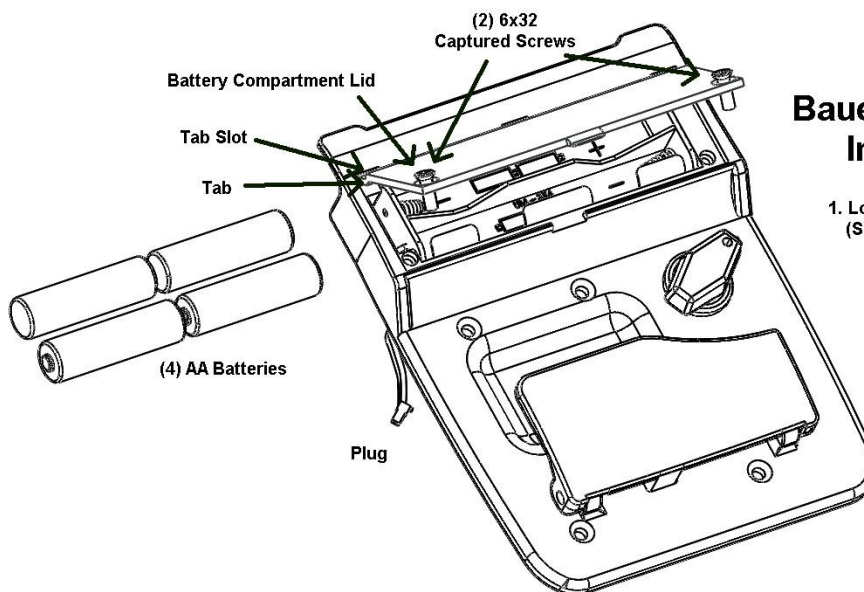

Bauer EM Battery Installation

1. Loosen (2) 6x32 Captured Screws
(Screws will remain with Battery
Compartment Lid)

2. Install 4 fresh AA Batteries
according to the orientation
symbols.

3. Install Battery Compartment Lid by
Aligning the (3) tabs and (3) slots.

4. Tighten (2) 6x32 Captured Screws
to attach Battery Compartment Lid.

Bauer EM Strike Plate

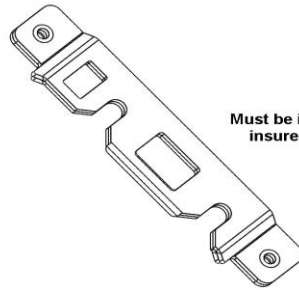

Must be installed with Bauer EM to insure FMVSS206 compliance

Bauer EM Installation

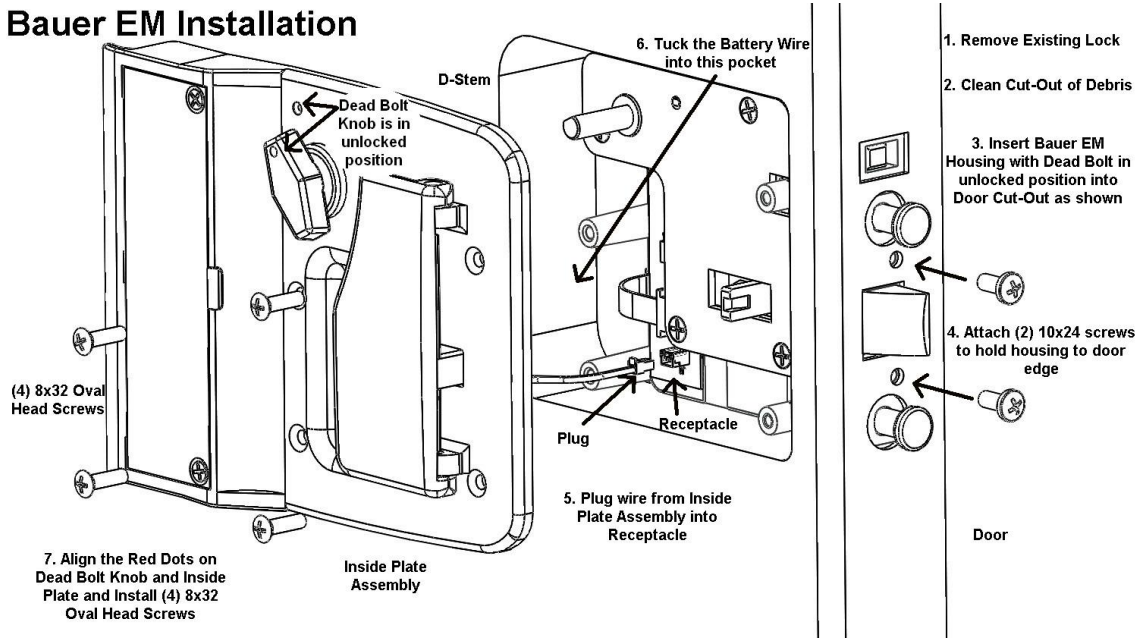

Battery Plug Instructions

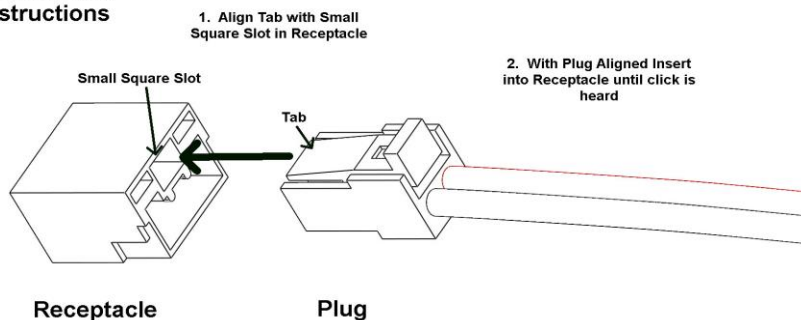

Limited Warranty

BAUER'S WARRANTY IS LIMITED. AT ITS SOLE DISCRETION, BAUER MAY EITHER REPLACE OR REPAIR ANY DEFECTIVE PARTS. IN NO EVENT SHALL BAUER HAVE ANY LIABILITY TO CUSTOMER FOR PAYING INCIDENTAL, SPECIAL OR CONSEQUENTIAL DAMAGES INCLUDING (WITHOUT LIMITATION) DAMAGES RESULTING FROM PERSONAL OR BODILY INJURY OR DEATH OR DAMAGES TO, OR LOSS OF USE OF, ANY PROPERTY. NOTWITHSTANDING ANY PROVISION TO THE CONTRARY, THIS LIMITED WARRANTY IS MADE UPON THE EXPRESS UNDERSTANDING THAT IT SHALL APPLY IN CONNECTION WITH THE SALE OF THE PRODUCT BY BAUER AND IS IN LIEU OF ALL OTHER WARRANTIES (EXPRESS, IMPLIED OR STATUTORY) INCLUDING THE SEPARATE WARRANTIES OF MERCHANTABILITY AND FITNESS FOR A PARTICULAR PURPOSE OR USE.